

A large, abstract blue graphic at the top of the page, resembling a stylized wave or a series of overlapping, curved lines that create a sense of motion and depth.

Instructions For Use

Type 100 Ti Fixed-Angle Rotor

For Use in Beckman Coulter
Class R and S
Preparative Ultracentrifuges



LXL-TB-008AK
January 2018



Beckman Coulter, Inc.
250 S. Kraemer Blvd.
Brea, CA 92821 U.S.A.



Type 100 Ti Fixed-Angle Rotor

LXL-TB-008AK (January 2018)

© 2018 Beckman Coulter, Inc.

All rights reserved.

Beckman Coulter, the stylized logo, and the Beckman Coulter product and service marks mentioned herein are trademarks or registered trademarks of Beckman Coulter, Inc. in the United States and other countries.

All other trademarks are trademarks or registered trademarks of their respective holders.

Contact Us

If you have any questions, contact our Customer Support Center.

- Worldwide, find us via our website at www.beckmancoulter.com/customersupport/support
- In the USA and Canada, call us at 1-800-369-0333.
- Outside of the USA and Canada, contact your local Beckman Coulter Representative.

Find us on the World Wide Web at:

www.beckmancoulter.com



Beckman Coulter Eurocenter S.A.
22, rue Juste-Olivier
Case Postale 1044
CH - 1260 Nyon 1, Switzerland
Tel: +41 (0) 22 365 36 11

Original Instructions

Revision History

This document applies to the latest software listed and higher versions. When a subsequent software version changes the information in this document, a new issue will be released.

Issue AJ, 09/2016

Changes were made to Temperature Limits.

Issue AK, 01/2018

Changes were made to [Specifications](#); [Table 1, Available Tubes for the Type 100 Ti Rotor](#); [Table 2, Relative Centrifugal Fields for the Type 100 Ti Rotor](#).

Note: Changes that are part of the most recent revision are indicated in text by a bar in the margin of the amended page.

Safety Notice

Read all product manuals and consult with Beckman Coulter-trained personnel before attempting to use this equipment. Do not attempt to perform any procedure before carefully reading all instructions. Always follow product labeling and manufacturer's recommendations. If in doubt as to how to proceed in any situation, contact your Beckman Coulter Representative.



This safety notice summarizes information basic to the safe use of the rotor described in this manual. The international symbol displayed to the left is a reminder to the user that all safety instructions should be read and understood before operation or maintenance of this equipment is attempted. When you see the symbol on other pages of this publication, pay special attention to the safety information presented. Observance of safety precautions will also help to avoid actions that could damage or adversely affect the performance of the rotor. This rotor was developed, manufactured, and tested for safety and reliability as part of a Beckman Coulter ultracentrifuge/rotor system. Its safety or reliability cannot be assured if used in a centrifuge not of Beckman Coulter's manufacture or in a Beckman Coulter ultracentrifuge that has been modified without Beckman Coulter's approval.

Alerts for Danger, Warning, Caution, and Note



DANGER

DANGER indicates an imminently hazardous situation which, if not avoided, will result in death or serious injury.



WARNING

WARNING indicates a potentially hazardous situation which, if not avoided, could result in death or serious injury.



CAUTION

CAUTION indicates a potentially hazardous situation, which, if not avoided, may result in minor or moderate injury. It may also be used to alert against unsafe practices.

NOTE NOTE is used to call attention to notable information that should be followed during installation, use, or servicing of this equipment.

Safety Information for the Type 100 Ti Rotor

Handle body fluids with care because they can transmit disease. No known test offers complete assurance that such fluids are free of micro-organisms. Some of the most virulent—Hepatitis (B and C) viruses, HIV (I–V), atypical mycobacteria, and certain systemic fungi—further emphasize the need for aerosol protection. Handle other infectious samples according to good laboratory

Safety Notice

Safety Information for the Type 100 Ti Rotor

procedures and methods to prevent spread of disease. Because spills may generate aerosols, observe proper safety precautions for aerosol containment. Do not run toxic, pathogenic, or radioactive materials in this rotor without taking appropriate safety precautions. Biosafe containment should be used when Risk Group II materials (as identified in the World Health Organization *Laboratory Biosafety Manual*) are handled; materials of a higher group require more than one level of protection.

The rotor and accessories are not designed for use with materials capable of developing flammable or explosive vapors. Do not centrifuge such materials in nor handle or store them near the ultracentrifuge.

Although rotor components and accessories made by other manufacturers may fit in the Type 100 Ti rotor, their safety in this rotor cannot be ascertained by Beckman Coulter. Use of other manufacturer's components or accessories in the Type 100 Ti rotor may void the rotor warranty and should be prohibited by your laboratory safety officer. Only the components and accessories listed in this publication should be used in this rotor.

Place filled tubes in at least two opposing cavities. Make sure that filled containers are loaded symmetrically into the rotor and that opposing tubes are filled to the same level with liquid of the same density. Make sure that cavities in use have the proper floating spacers and/or spacers inserted (if applicable) before installing the rotor lid. Do not put spacers in cavities that do not contain tubes.

If disassembly reveals evidence of leakage, you should assume that some fluid escaped the rotor. Apply appropriate decontamination procedures to the centrifuge and accessories.

Never exceed the maximum rated speed of the rotor and labware in use. Refer to the section on [Run Speeds](#), and derate the run speed as appropriate.

Do not use sharp tools on the rotor that could cause scratches in the rotor surface. Corrosion begins in scratches and may open fissures in the rotor with continued use.

Contents

Revision History, iii

Safety Notice, v

Alerts for Danger, Warning, Caution, and Note, v

Safety Information for the Type 100 Ti Rotor, v

Type 100 Ti Fixed-Angle Rotor, 1

Specifications, 1

Description, 2

Preparation and Use, 3

Prerun Safety Checks, 3

Rotor Preparation, 4

Operation, 5

Removal and Sample Recovery, 5

Tubes and Accessories, 6

Temperature Limits, 7

Quick Seal Tubes, 7

Run Times, 7

Run Speeds, 9

Slow Acceleration/Deceleration, 13

Selecting CsCl Gradients, 13

Adjusting Fill Volumes, 13

Typical Examples for Determining CsCl Run Parameters, 14

Care and Maintenance, 15

Maintenance, 15

Cleaning, 16

Decontamination, 17

Sterilization and Disinfection, 17

Storage, 18

Returning a Rotor, 18

Supply List, 18

Replacement Rotor Parts, 19

Other, 19

Illustrations

- 1 Arranging Tubes in the Rotor, 4
- 2 Precipitation Curves for the Type 100 Ti Rotor, 11
- 3 CsCl Gradients at Equilibrium for the Type 100 Ti Rotor, 12

Tables

- | | |
|---|---|
| 1 | Available Tubes for the Type 100 Ti Rotor, 6 |
| 2 | Relative Centrifugal Fields for the Type 100 Ti Rotor, 10 |

Type 100 Ti Fixed-Angle Rotor

Specifications

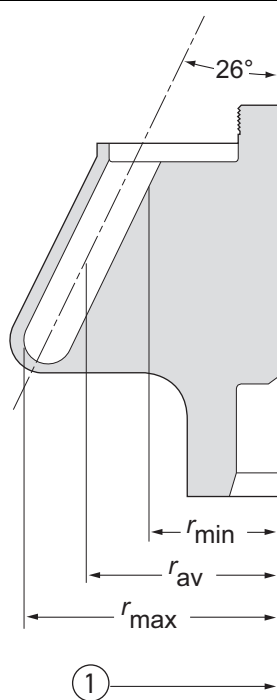

1. Axis of Rotation

Maximum speed	100,000 RPM
Density rating at maximum speed	1.2 g/mL
Relative Centrifugal Field ^a at maximum speed	
At r_{max} (71.6 mm)	$801,920 \times g$
At r_{av} (55.5 mm)	$622,000 \times g$
At r_{min} (39.7 mm)	$442,000 \times g$
k factor at maximum speed	15
Conditions requiring speed reductions	see Run Speeds
Number of tube cavities	8
Available tubes	see Table 1
Nominal tube dimensions (largest tube)	13 × 64 mm
Nominal tube capacity (largest tube)	6.8 mL
Nominal rotor capacity	54 mL
Approximate acceleration time to maximum speed (fully loaded) ^b	5 1/2 min
Approximate deceleration time from maximum speed (fully loaded) ^b	3 1/2 min
Weight of empty rotor	3.9 kg (8.6 lb)
Weight of fully loaded rotor	4.1 kg (9 lb)
Rotor material	titanium

a. Relative Centrifugal Field (RCF) is the ratio of the centrifugal acceleration at a specified radius and speed ($r\omega^2$) to the standard acceleration of gravity (g) according to the following formula: $RCF = r\omega^2/g$ — where r is the radius in millimeters, ω is the angular velocity in radians per second ($2\pi \text{ RPM}/60$), and g is the standard acceleration of gravity (9807 mm/s^2). After substitution: $RCF = 1.12r (\text{RPM}/1000)^2$

b. Time may vary depending on which instrument is used.

Description

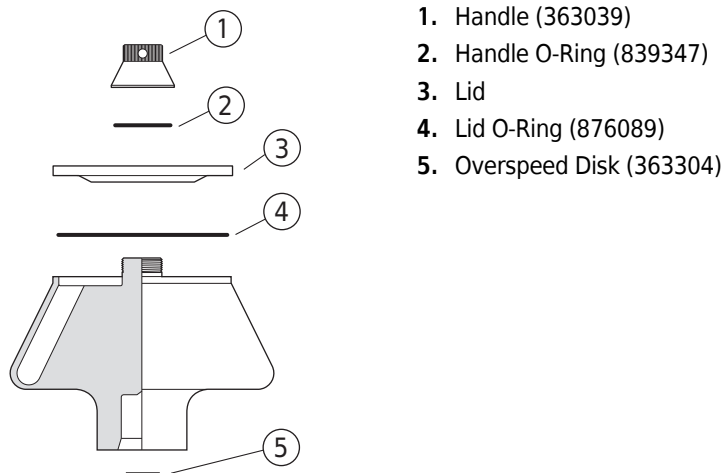

This Beckman Coulter rotor has been manufactured in an ISO 9001 or 13485 facility for use with the specified Beckman Coulter ultracentrifuges.

The Type 100 Ti is a fixed angle rotor designed to centrifuge up to eight Quick-Seal tubes at a 26-degree angle to the axis of rotation. Used in Beckman Coulter Class R and S preparative ultracentrifuges, the rotor develops centrifugal forces sufficient to pellet ribosomes or other micromolecules. It can also be used to purify and separate DNA, proteins, and other small particles in solution using density gradient techniques. Approximately 48 mL of gradient and sample can be centrifuged per run.

NOTE Certain models of the Optima series ultracentrifuges may require software updates in order to run this rotor. Contact Beckman Coulter Field Service.

The rotor is made of titanium and is finished with black polyurethane paint. The lid and handle are made of anodized aluminum. O-rings made of Buna N rubber in the rotor handle and lid maintain atmospheric pressure inside the rotor during centrifugation, if they are properly lubricated.

Because of the weight of the rotor, drive pins are not required in the rotor drive hub cavity.

For overspeed protection, a Beckman Coulter ultracentrifuge equipped with a photoelectric detector will monitor the overspeed disk on the adapter bottom and shut down the run if a speed exceeding the maximum allowable speed is detected.

See the Warranty at the back of this manual for warranty information.

Preparation and Use

Specific information about the Type 100 rotor is given here. Information common to this and other rotors is contained in *Rotors and Tubes for Preparative Ultracentrifuges* (publication LR-IM), which should be used together with this manual for complete rotor and accessory operation. Publication LR-IM is included in the literature package with this rotor manual.

NOTE Although rotor components and accessories made by other manufacturers may fit in the Type 100 Ti rotor, their safety in this rotor cannot be ascertained by Beckman Coulter. Use of other manufacturers' components or accessories in the Type 100 Ti rotor may void the rotor warranty and should be prohibited by your laboratory safety officer. Only the components and accessories listed in this publication should be used in this rotor.

Prerun Safety Checks



Read the [Safety Notice](#) section at the front of this manual before using the rotor.

- 1 Make sure that the rotor and lid are clean and show no signs of corrosion or cracking.
- 2 Make sure that the rotor is equipped with the correct overspeed disk (363304).
 - a. If the disk is missing or damaged, replace it according to the instructions in *Rotors and Tubes*.



- 3 Verify that only the tubes and accessories listed in [Table 1](#) are being used.
- 4 Check the chemical compatibilities of all materials used.
 - Refer to *Chemical Resistances* (publication IN-175), included in the *Rotors and Tubes* CD.

Rotor Preparation

For runs at other than room temperature refrigerate or warm the rotor beforehand for fast equilibration.

- 1 Be sure that metal threads in the rotor are clean and lightly but evenly lubricated with Spinkote lubricant (306812).
 - a. Also ensure that O-rings are lightly but evenly coated with silicone vacuum grease.
- 2 Load the filled and sealed tubes symmetrically into the rotor (see page 6 for tube and accessory information).
 - a. If fewer than eight tubes are being run, they must be arranged symmetrically in the rotor (see [Figure 1](#)).
 - b. Opposing tubes must be filled to the same level with liquid of the same density.

Figure 1 Arranging Tubes in the Rotor

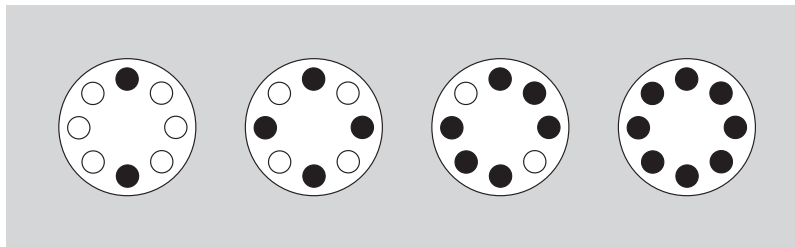

NOTE Two, four, six, or eight tubes can be centrifuged per run if they are arranged in the rotor as shown.

- 3 Complete loading by placing the correct floating spacers over the tubes.

NOTE Place filled tubes in at least two opposing cavities. Make sure that cavities in use also have the proper spacers inserted before installing the rotor lid. Do not put spacers in cavities that do not contain tubes.
- 4 Put the lid in place and tighten, as firmly as possible, with the handle tool (356959) provided.
 - a. Remove the handle tool.

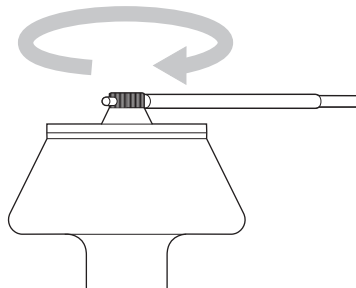

Operation

- 1 Carefully lower the rotor straight down onto the drive hub.

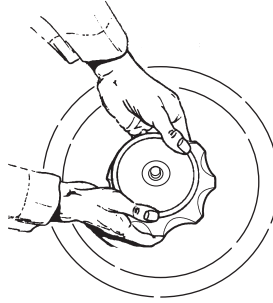

- 2 Refer to the instrument instruction manual for ultracentrifuge operation.
- 3 For additional operating information, see the following:
 - [Run Times](#), page 7, for using k factors to adjust run durations.
 - [Run Speeds](#), page 9, for information about speed limitations.
 - [Slow Acceleration/Deceleration](#), page 13, for information about using slow acceleration and deceleration for gradient stability when preformed gradients are used
 - [Selecting CsCl Gradients](#), page 13, for methods to avoid CsCl precipitation during centrifugation.

Removal and Sample Recovery

CAUTION

If disassembly reveals evidence of leakage, you should assume that some fluid escaped the rotor. Apply appropriate decontamination procedures to the centrifuge and accessories.

- 1 Remove the rotor from the centrifuge by lifting it straight up and off the drive hub.
- 2 Remove the rotor lid.

3 Use the removal tool (361668) to remove the spacers and tubes.

NOTE The extremely high centrifugal forces of an ultra-high-speed rotor cause a slight vacuum to build up in the tube cavities, occasionally resulting in a suction effect when removing the tubes from the rotor. Some tube deformation may also occur. A brief delay (approximately 5 minutes) after the rotor comes to rest before removing the tubes will make tube removal easier. If you experience difficulty in removing the tubes from the rotor, use a gentle twisting or rocking motion, and remove the tube slowly to avoid sample mixing.

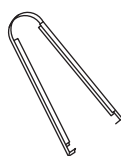

Tube Removal Tool (368668)

Tubes and Accessories

The Type 100 Ti rotor uses only the Quick-Seal tubes and accessories listed in [Table 1](#); be sure to use only those items. Refer to *Rotors and Tubes* for information on the chemical resistances of tube and accessory materials.

Table 1 Available Tubes for the Type 100 Ti Rotor^a

Tube			Required Accessory		Max Speed/RCF/ k factor
Dimensions/Nominal Volume/	Description	Part Number	Description	Part Number	
13 × 57 mm 6.0 mL	Quick-Seal polypropylene, bell-top	344619 (pkg/50)	Noryl ^b floating spacer	365470 (pkg/8)	100,000 RPM 801,920 × g 15
13 × 51 mm 5.1 mL	Quick-Seal polypropylene, bell-top	362248 ^c (pkg/50)	Noryl floating spacer	360270 (pkg/8)	100,000 RPM 801,920 × g 13.5
13 × 30 mm 3.5 mL	Quick-Seal polypropylene, bell-top	349621 ^d (pkg/50)	Noryl floating spacer	360270 (pkg/8)	100,000 RPM 801,920 × g 9.4
13 × 25 mm 2.0 mL	Quick-Seal polypropylene, bell-top	345829 ^e (pkg/50)	Noryl floating spacer	360270 (pkg/8)	55,000 RPM 801,920 × g 7

- Use only the items listed here..
- Noryl is a registered trademark of GE Plastics.
- Tube 362248 is also available as part of g-Max Kit 363960..
- Tube 349621 is also available as part of g-Max Kit 363961.
- Tube 345829 is also available as part of g-Max Kit 363962.



Temperature Limits

- Plastic tubes have been centrifuge tested for use at temperatures between 2 and 25°C. For centrifugation at other temperatures, pretest tubes under anticipated run conditions.
- If plastic containers are frozen before use, make sure that they are thawed to at least 2°C prior to centrifugation.

Quick Seal Tubes

Quick-Seal tubes must be sealed prior to centrifugation. These tubes are heat sealed and do not need caps; however, spacers are required on top of the tubes when they are loaded into the rotor buckets.

- 1 Fill Quick-Seal tubes leaving a *small* bubble of air at the base of the neck.
 - a. Do not leave a large air space—too much air can cause excessive tube deformation.
- 2 Some of the Quick-Seal tubes listed in [Table 1](#) are part of the *g*-Max system, which uses a combination of small bell-top Quick-Seal tubes and floating spacers (also called *g*-Max spacers).
 - This means that you can run the shorter tubes listed in [Table 1](#) in the Type 100 Ti rotor without reduction in *g* force.
 - For detailed information on the *g*-Max system see publication DS-709.

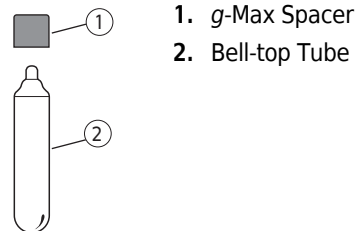

- 3 Refer to *Rotors and Tubes* for detailed information on the use and care of Quick-Seal tubes.
 - Quick-Seal tubes are disposable and should be discarded after a single use.

Run Times

The *k* factor of the rotor is a measure of the rotor's pelleting efficiency. (Beckman Coulter has calculated the *k* factors for all of its preparative rotors at maximum rated speed and using full tubes.) The *k* factor is calculated from the formula

$$k = \frac{\ln(r_{\max}/r_{\min})}{\omega^2} \times \frac{10^{13}}{3600}$$

EQ 1

where ω is the angular velocity of the rotor in radians per second ($\omega = 0.105 \times \text{RPM}$), r_{\max} is the maximum radius, and r_{\min} is the minimum radius.

After substitution:

EQ 2

$$k = \frac{(2.533 \times 10^{11}) \ln(r_{\max}/r_{\min})}{\text{RPM}^2}$$

Use the k factor in the following equation to estimate the run time t (in hours) required to pellet particles of known sedimentation coefficient s (in Svedberg units, S).

EQ 3

$$t = \frac{k}{s}$$

Run times can be estimated for centrifugation at less than maximum speed by adjusting the k factor as follows:

EQ 4

$$k_{\text{adj}} = k \left(\frac{100,000}{\text{actual run speed}} \right)^2$$

Run times can also be estimated from data established in prior experiments if the k factor of the previous rotor is known. For any two rotors, a and b :

EQ 5

$$\frac{t_a}{t_b} = \frac{k_a}{k_b}$$

Run Speeds

The centrifugal force at a given radius in a rotor is a function of speed. Comparisons of forces between different rotors are made by comparing the rotors' relative centrifugal fields (RCF). When rotational speed is adjusted so that identical samples are subjected to the same RCF in two different rotors, the samples are subjected to the same force. The RCF at a number of rotor speeds is provided in [Table 2](#).

Speeds must be reduced under the following circumstances:

1. If nonprecipitating solutions more dense than 1.2 g/mL are centrifuged, the maximum allowable run speed must be reduced according to the following equation:

EQ 6

$$\text{reduced maximum speed} = (100,000 \text{ RPM}) \sqrt{\frac{1.2 \text{ g/mL}}{\rho}}$$

where ρ is the density of the tube contents. This speed reduction will protect the rotor from excessive stresses due to the added tube load. *Note, however, that the use of this formula may still produce maximum speed figures that are higher than the limitations imposed by the use of certain tubes or adapters.* In such cases, use the lower of the two figures.

2. *Further speed limits must be imposed* when CsCl or other self-forming-gradient salts are centrifuged, as equation (6) does not predict concentration limits/speeds that are required to avoid precipitation of salt crystals. Precipitation during centrifugation would alter the density distribution of CsCl and this would change the position of the sample bands. [Figure 2](#) and [Figure 3](#), together with the description and examples below, show how to reduce run speeds when using CsCl gradients.

Table 2 Relative Centrifugal Fields for the Type 100 Ti Rotor^a

Rotor Speed (RPM)	Relative Centrifugal Field ($\times g$)			k Factor ^b
	At r_{\max} (71.6 mm)	At r_{av} (55.5 mm)	At r_{\min} (39.5 mm)	
100,000	801,920	622,000	442,000	15
95,000	724,000	561,000	399,000	17
90,000	650,000	504,000	358,000	19
85,000	580,000	449,000	320,000	21
80,000	513,000	389,000	283,000	24
75,000	451,000	350,000	249,000	27
70,000	393,000	305,000	217,000	31
65,000	339,000	263,000	187,000	36
60,000	289,000	224,000	159,000	42
55,000	243,000	188,000	134,000	50
50,000	201,000	155,000	111,000	60
45,000	162,000	126,000	89,600	74
40,000	128,000	99,500	70,800	94
35,000	98,200	76,200	54,200	123
30,000	72,200	55,900	39,800	167
25,000	50,100	38,900	27,700	241

- a. Entries in this table are calculated from the formula $RCF = 1.12r(RPM/1000)^2$ and then rounded to three significant digits.
- b. Calculated for all Beckman Coulter preparative rotors as a measure of the rotor's relative efficiency in pelleting sample in water at 20°C.

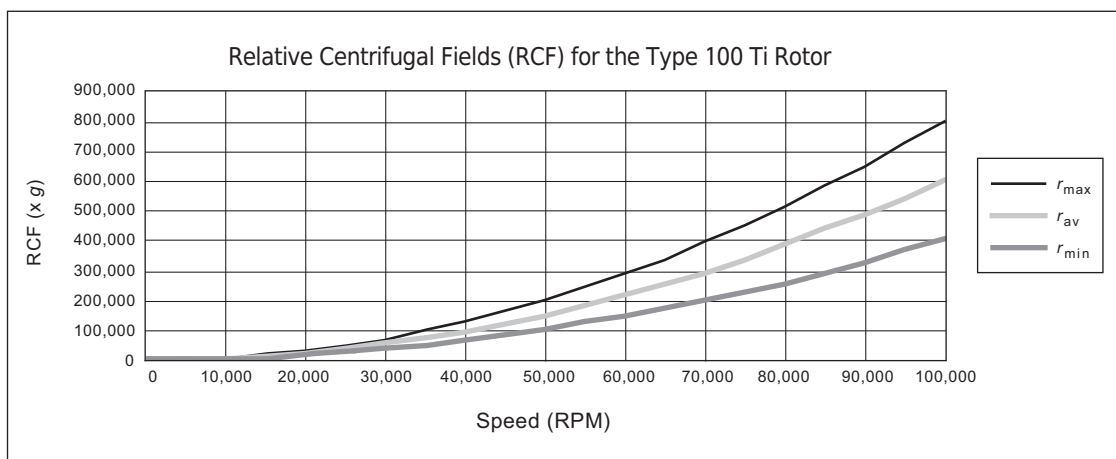
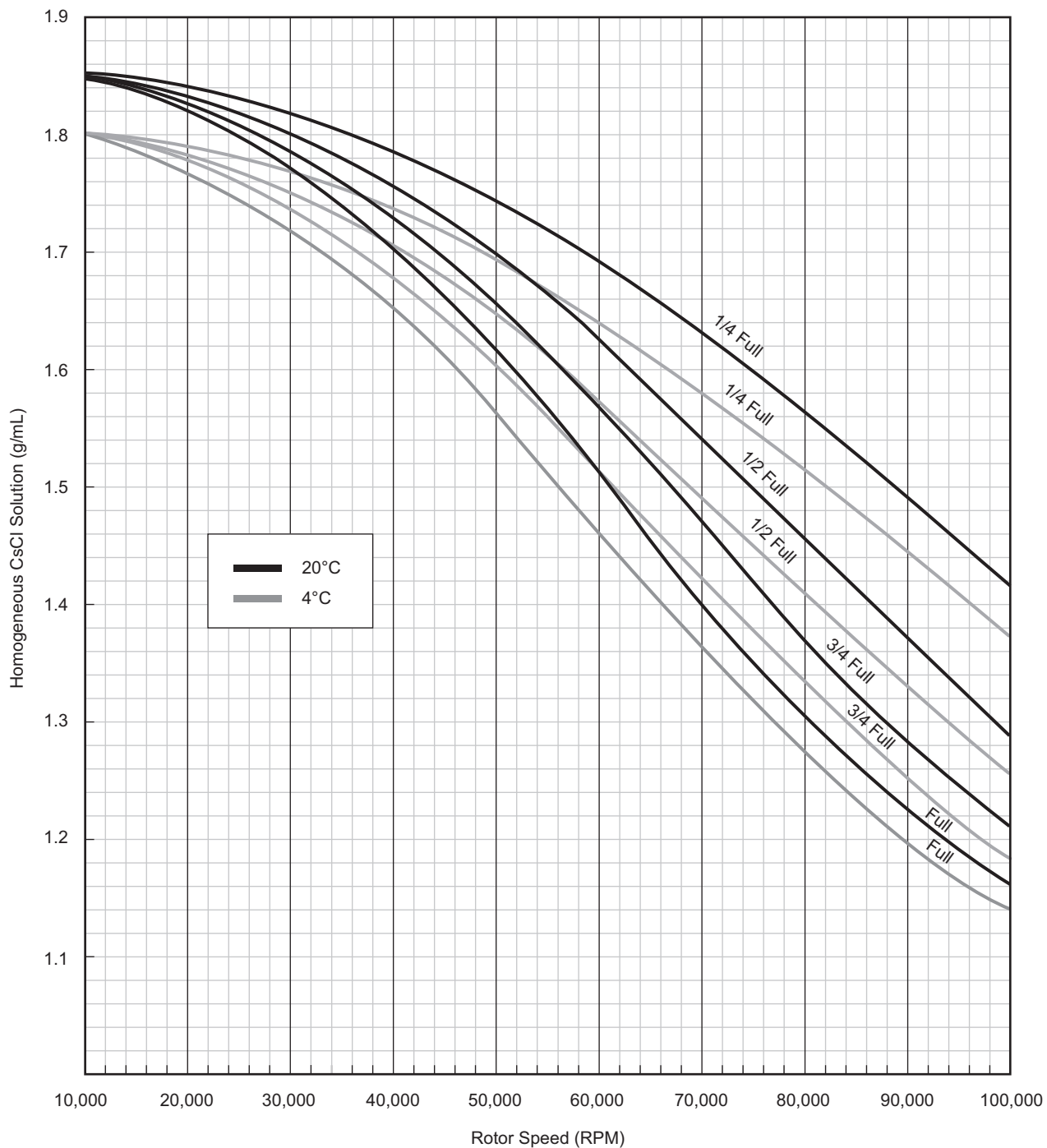
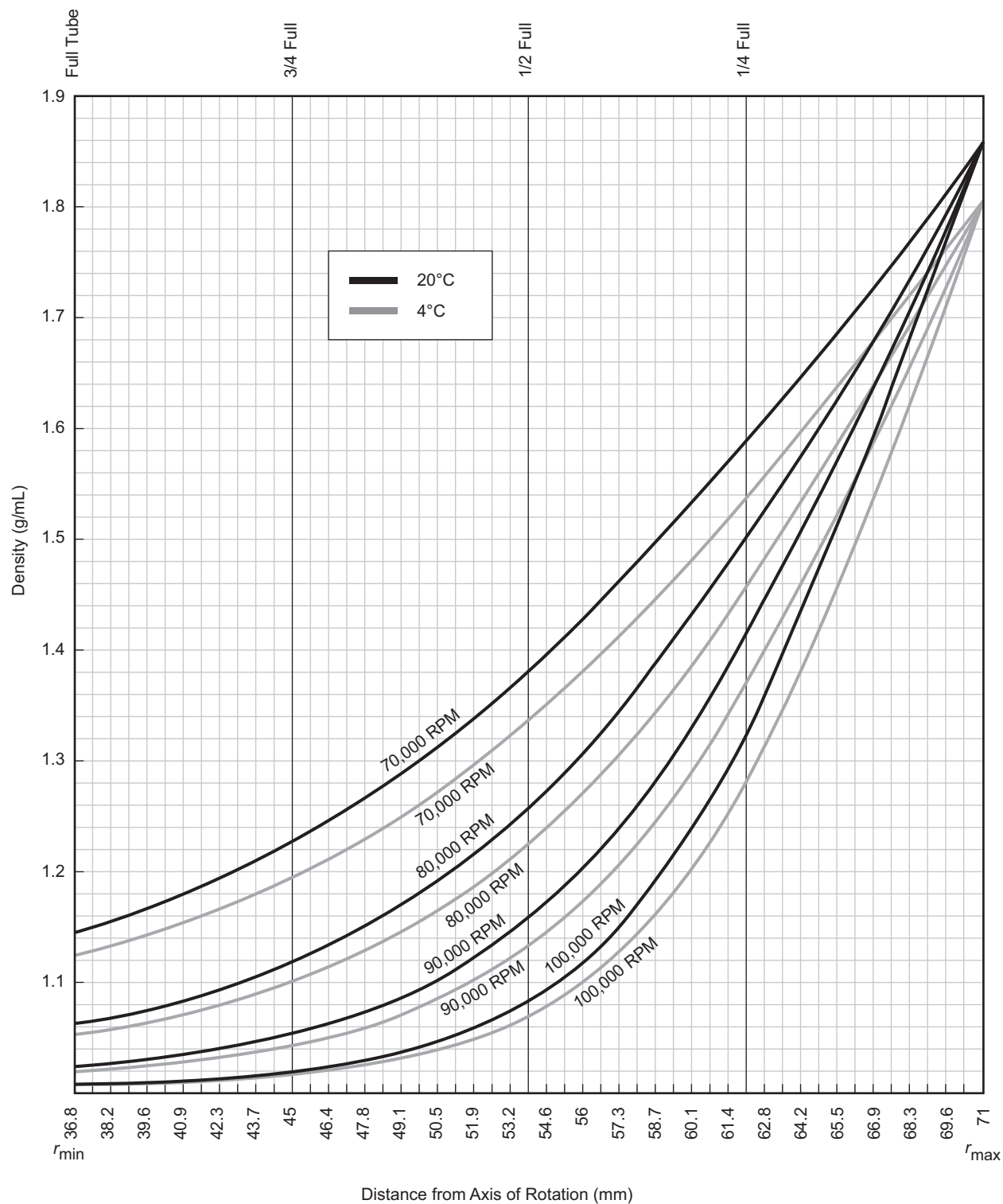

Figure 2 Precipitation Curves for the Type 100 Ti Rotor*



* Using combinations of rotor speeds and homogeneous CsCl solution densities that intersect on or below these curves ensures that CsCl will not precipitate during centrifugation. The curves shown here and in Figure 3 represent the 6.0 mL Quick-Seal tube.

Figure 3 CsCl Gradients at Equilibrium for the Type 100 Ti Rotor*



* Centrifugation of homogeneous CsCl solutions at the maximum allowable speeds (from Figure 2) results in gradients presented here.

Slow Acceleration/Deceleration

Vertical banding of sample and gradient formation occurs with centrifugation. With deceleration, tube contents reorient back to horizontal position. For gradient stability when *performed gradients are used*, select a slow acceleration profile. For the stability of all gradients during deceleration, select a slow deceleration profile. Refer to the appropriate centrifuge user manual for instructions on selecting acceleration and deceleration rates.

Selecting CsCl Gradients



Rotor speed is used to control the slope of a CsCl density gradient, and must be limited so that CsCl precipitation is avoided. Precipitation during centrifugation would alter density distribution, and this would change the position of the sample bands. Curves in [Figure 2](#) and [Figure 3](#) are provided up to the maximum rated speed of the rotor.

NOTE The curves in [Figure 2](#) and [Figure 3](#) are for solutions of CsCl salt dissolved in distilled water only. If other salts are present in significant concentrations, the overall CsCl concentration may need to be reduced.

Speed and density combinations that intersect on or below the curves in [Figure 3](#) ensure that CsCl will not precipitate during centrifugation in the Type 100 Ti rotor. Curves are provided at two temperatures: 20°C (black curves) and 4°C (gray curves).

The reference curves in [Figure 3](#) show gradient distribution at equilibrium. Each curve in [Figure 3](#) is within the density limits allowed for the Type 100 Ti rotor: each curve was generated for a single run speed using the maximum allowable homogeneous CsCl densities (one for each fill level) that avoid precipitation at that speed. (The gradients in [Figure 3](#) can be generated from step or linear gradients, or from homogeneous solutions. But the total amount of CsCl in solution must be equivalent to a homogeneous solution corresponding to the concentrations specified in [Figure 2](#).) [Figure 3](#) can also be used to approximate the banding positions of sample particles.

Adjusting Fill Volumes

[Figure 2](#) and [Figure 3](#) show that several fill volumes are possible in a tube. (The curves shown are for the 6-mL tube, 344619. The 3.5-mL tube, 349621, is half as long as the tube shown; therefore, a *full* 3.5-mL tube would be approximately the same as a *half-full* 6.0-mL tube.) If a tube is partially filled with gradient solution, float mineral oil (or some other low-density, immiscible liquid) on top of the tube contents to fill the tube to its maximum volume. Note that for a given CsCl density, as the fill level decreases the maximum allowable speed increases. Partial filling may be desirable when there is little sample or when you wish to shorten the run time.

For example, a *half-filled* tube of 1.40-g/mL homogeneous CsCl solution at 20°C may be centrifuged at 88,000 RPM (see [Figure 2](#)). The same solution in a *three-quarter-filled* tube may be centrifuged no faster than 78,000 RPM. A tube full of the 1.40-g/mL CsCl solution may be centrifuged no faster than 70,000 RPM.

Typical Examples for Determining CsCl Run Parameters

Example A:

Knowing homogeneous CsCl solution density (such as 1.50 g/mL) and approximate particle buoyant densities (1.60 and 1.70 g/mL), at 4°C, where will particles band?

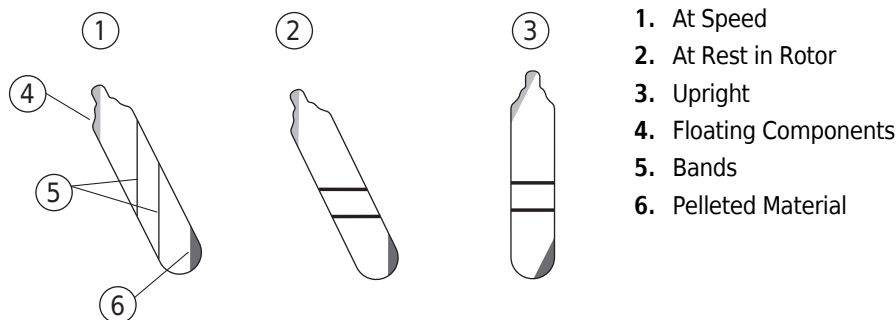

- 1 In [Figure 2](#) find the curve that corresponds to the desired run temperature (4°C).
 - The maximum allowable rotor speed is determined from the point where this curve intersects the homogeneous CsCl density (68,000 RPM).
- 2 In [Figure 3](#), sketch in a horizontal line corresponding to each particle's buoyant density.
- 3 Mark the point in the figure where each particle density intersects the curve corresponding to the selected run speed and temperature.
 - (Gradient curves not shown in [Figure 3](#) can be interpolated.)
 - Particles will band at these locations across the tube diameter at equilibrium during centrifugation.

In this example, particles will band about 66.3 and 64.2 mm from the axis of rotation, about 2.1 mm of centerband-to-centerband separation at the rotor's 26-degree tube angle. When the tube is removed from the rotor and held upright (vertical and stationary), there will be about 2.3 mm of centerband-to-centerband separation. This interband distance, d_{up} , can be calculated from the formula:

EQ 7

$$d_{up} = \frac{d_{\theta}}{\cos \theta}$$

where d_{θ} is the interband distance when the tube is held at an angle, θ , in the rotor.

Example B:

Knowing particle buoyant densities (e.g., 1.65 and 1.70 g/mL), how do you achieve good separation?

- 1 In [Figure 3](#), sketch in a horizontal line corresponding to each particle's buoyant density.
- 2 Select the curve at the desired temperature (20°C) that gives the best particle separation.
- 3 Note the run speed along the selected curve (70,000 RPM).
- 4 From [Figure 2](#), select the maximum homogeneous CsCl density (in this case, 1.41 g/mL) that corresponds to the temperature and run speed established above.
 - These parameters will provide the particle-banding pattern selected in Step 2.

In this example, particles will band at about 64 and 65.2 mm from the axis of rotation (about 1.2 mm apart). When the tube is held upright there will be about 1.3 mm of center-of-band to center-of-band separation.

Care and Maintenance

Maintenance

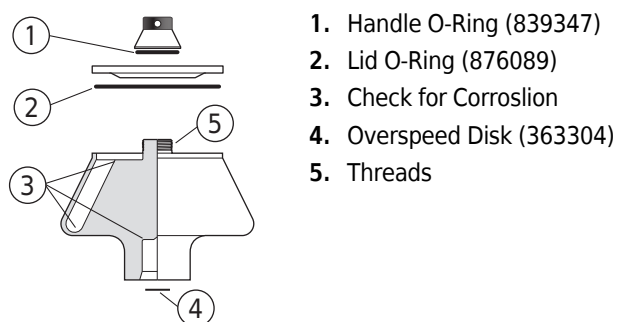

NOTE Do not use sharp tools on the rotor that could cause scratches in the rotor surface. Corrosion begins in scratches and may open fissures in the rotor with continued use.

- 1 Regularly inspect the overspeed disk.
 - a. If it is scratched, damaged, or missing, replace it.
 - Replacement instructions are in *Rotors and Tubes*.

- 2 Regularly lubricate the metal threads in the rotor and handle with a thin, even coat of Spinkote lubricant.
 - Failure to keep these threads lubricated can result in damaged threads.
- 3 Regularly apply silicone vacuum grease to the O-rings.
 - a. Replace O-rings about twice a year or whenever worn or damaged.
- 4 Refer to Appendix A in *Rotors and Tubes* for the chemical resistances of rotor and accessory materials.
 - Your Beckman Coulter representative provides contact with the Field Rotor Inspection Program and the rotor repair center.

Cleaning

Wash the rotor and rotor components immediately if salts or other corrosive materials are used or if spillage has occurred. Do not allow corrosive materials to dry on the rotor.

Under normal use, wash the rotor frequently (at least weekly) to prevent buildup of residues.

- 1 Remove the O-rings before washing.
- 2 Wash the rotor and lid in a mild detergent, such as Beckman Solution 555, that won't damage the rotor.
 - a. Dilute the detergent 10 to 1 with water.

NOTE Do not wash rotor components in a dishwasher. Do not soak in detergent solution for long periods, such as overnight.

 - The Rotor Cleaning Kit contains two plastic-coated brushes and two quarts of Solution 555 (339555) for use with rotors and accessories.
- 3 Rinse the cleaned rotor and components with distilled water.
- 4 Air-dry the rotor and lid upside down.
 - a. *Do not use acetone to dry the rotor.*
- 5 Apply a thin, even coat of silicone vacuum grease (335148) to the lid O-ring, then replace it in the groove in the outer rim of the lid.



- 6 Clean metal threads every 6 months, or as necessary.
 - a. Use a brush and concentrated Solution 555.
 - b. Rinse and dry thoroughly, then lubricate lightly but evenly with Spinkote to coat all threads.

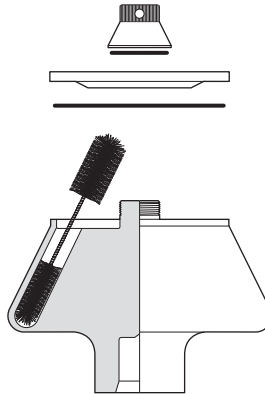

- 7 Periodically remove the O-rings and wipe clean as necessary.
 - a. Clean the O-ring grooves with a cotton-tipped swab.
 - b. Reapply a light film of silicone vacuum grease.

Decontamination



If the rotor or other components are contaminated with toxic, radioactive, or pathogenic materials, follow appropriate decontamination procedures as outlined by your laboratory safety officer. Refer to Appendix A in *Rotors and Tubes* to select solutions that will not damage the rotor and accessory materials.

Sterilization and Disinfection

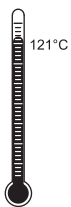

- The rotor and all rotor components, except those made of Noryl, can be autoclaved at 121°C for up to an hour. Remove the plugs from the rotor and place the rotor, plugs, and spacers in the autoclave upside down.
- Ethanol (70%)* or hydrogen peroxide (6%) may be used on all rotor components, including those made of plastic. Bleach (sodium hypochlorite) may be used, but may cause discoloration of anodized surfaces. Use the minimum immersion time for each solution, per laboratory standards.

* Flammability hazard. Do not use in or near operating ultracentrifuges.

While Beckman Coulter has tested these methods and found that they do not damage the rotor or components, no guarantee of sterility or disinfection is expressed or implied. When sterilization or disinfection is a concern, consult your laboratory safety officer regarding proper methods to use.

Refer to publication IN-192 (included with each box of tubes) for tube sterilization and disinfection procedures. *Quick-Seal, Ultra Clear, and thinwall open-top tubes are disposable and should be discarded after a single use.*

Storage

When it is not in use, store the rotor in a dry environment (not in the instrument) with the lid removed to allow air circulation so moisture will not collect in the tube cavities.

Returning a Rotor

Before returning a rotor or accessory for any reason, prior permission must be obtained from Beckman Coulter, Inc. This form may be obtained from your local Beckman Coulter sales office. The form, entitled *Returned Material Authorization (RMA)* for United States returns or *Returned Goods Authorization (RGA)* for international returns, should contain the following information:

- rotor type and serial number,
- history of use (approximate frequency of use),
- reason for the return,
- original purchase order number, billing number, and shipping number, if possible,
- name and email address of the person to be notified upon receipt of the rotor or accessory at the factory,
- name and email address of the person to be notified about repair costs, etc.

To protect our personnel, it is the customer's responsibility to ensure that all parts are free from pathogens and/or radioactivity. Sterilization and decontamination must be done before returning the parts. Smaller items (such as tubes, bottles, etc.) should be enclosed in a sealed plastic bag.

*All parts must be accompanied by a note, plainly visible on the outside of the box or bag, stating that they are safe to handle and that they are not contaminated with pathogens or radioactivity. **Failure to attach this notification will result in return or disposal of the items without review of the reported problem.***

Use the address label printed on the RMA/RGA form when mailing the rotor and/or accessories.

Customers located outside the United States should contact their local Beckman Coulter office.

Supply List

NOTE Publications referenced in this manual can be obtained at www.beckmancoulter.com, by calling Beckman Coulter at 1-800-742-2345 in the United States, or by contacting your local Beckman Coulter office.

See the Beckman Coulter *Ultracentrifuge Rotors, Tubes & Accessories* catalog (BR-8101, available at www.beckmancoulter.com) or contact Beckman Coulter Sales (1-800-742-2345 in the United States) for detailed information on ordering parts and supplies. For your convenience, a partial list is given below.

Replacement Rotor Parts

Description	Part Number
Type 100 Ti rotor assembly	363013
Rotor handle	363039
O-ring (lid)	876089
O-ring (handle)	839347
Overspeed disk (100,000 RPM)	363304

Other

NOTE For MSDS information, go to the Beckman Coulter website at www.beckmancoulter.com.

Description	Part Number
Tubes and spacers	see Table 1
Quick-Seal Cordless Tube Topper kit, 60 Hz	358312
Quick-Seal Cordless Tube Topper kit, 50 Hz (Europe)	358313
Quick-Seal Cordless Tube Topper kit, 50 Hz (Great Britain)	358314
Quick-Seal Cordless Tube Topper kit, 50 Hz (Australia)	358315
Quick-Seal Cordless Tube Topper kit, 50 Hz (Canada)	367803
Tube Topper rack (16-mm dia. tubes)	348122
Handle tool	356959
Tube removal tool (Quick-Seal tubes)	361668
Spinkote lubricant (2 oz)	306812
Silicone vacuum grease (1 oz)	335148
Rotor Cleaning Kit	339558
Beckman Solution 555 (1 qt)	339555
Rotor cleaning brush	339379
Centering tool (for overspeed disk replacement)	331325

Beckman Coulter, Inc.

Ultracentrifuge Rotor Warranty

All Beckman Coulter ultracentrifuge Fixed Angle, Vertical Tube, Near Vertical Tube, Swinging Bucket, and Airfuge rotors are warranted against defects in materials or workmanship for the time periods indicated below, subject to the Warranty Conditions stated below.

Preparative Ultracentrifuge Rotors	5 years — No Proration
Analytical Ultracentrifuge Rotors	5 years — No Proration
ML and TL Series Ultracentrifuge Rotors	5 years — No Proration
Airfuge Ultracentrifuge Rotors	1 year — No Proration
For Zonal, Continuous Flow, Component Test, and Rock Core Ultracentrifuge Rotors, see separate warranty.	

Warranty Conditions (as applicable)

1. This warranty is valid for the time periods indicated above from the date of shipment to the original Buyer by Beckman Coulter or an authorized Beckman Coulter representative.
2. This warranty extends only to the original Buyer and may not be assigned or extended to a third person without written consent of Beckman Coulter.
3. This warranty covers the Beckman Coulter Centrifuge Systems only (including but not limited to the centrifuge, rotor, and accessories) and Beckman Coulter shall not be liable for damage to or loss of the user's sample, non-Beckman Coulter tubes, adapters, or other rotor contents.
4. This warranty is void if the Beckman Coulter Centrifuge System is determined by Beckman Coulter to have been operated or maintained in a manner contrary to the instructions in the operator's manual(s) for the Beckman Coulter Centrifuge System components in use. This includes but is not limited to operator misuse, abuse, or negligence regarding indicated maintenance procedures, centrifuge and rotor classification requirements, proper speed reduction for the high density of certain fluids, tubes, and tube caps, speed reduction for precipitating gradient materials, and speed reduction for high-temperature operation.
5. Rotor bucket sets purchased concurrently with or subsequent to the purchase of a Swinging Bucket Rotor are warranted only for a term co-extensive with that of the rotor for which the bucket sets are purchased.
6. This warranty does not cover the failure of a Beckman Coulter rotor in a centrifuge not of Beckman Coulter manufacture, or if the rotor is used in a Beckman Coulter centrifuge that has been modified without the written permission of Beckman Coulter, or is used with carriers, buckets, belts, or other devices not of Beckman Coulter manufacture.
7. Rotor parts subject to wear, including but not limited to rotor O-rings, VTi, NVT, TLV, MLN, and TLN rotor tube cavity plugs and gaskets, tubing, tools, optical overspeed disks, bearings, seals, and lubrication are excluded from this warranty and should be frequently inspected and replaced if they become worn or damaged.
8. Keeping a rotor log is not mandatory, but may be desirable for maintenance of good laboratory practices.

Repair and Replacement Policies

1. If a Beckman Coulter rotor is determined by Beckman Coulter to be defective, Beckman Coulter will repair or replace it, subject to the Warranty Conditions. A replacement rotor will be warranted for the time remaining on the original rotor's warranty.
2. If a Beckman Coulter centrifuge is damaged due to a failure of a rotor covered by this warranty, Beckman Coulter will supply free of charge (i) all centrifuge parts required for repair (except the drive

unit, which will be replaced at the then current price less a credit determined by the total number of revolutions or years completed, provided that such a unit was manufactured or rebuilt by Beckman Coulter), and (ii) if the centrifuge is currently covered by a Beckman Coulter warranty or Full Service Agreement, all labor necessary for repair of the centrifuge.

3. If a Beckman Coulter rotor covered by this warranty is damaged due to a malfunction of a Beckman Coulter ultracentrifuge covered by an Ultracentrifuge System Service Agreement, Beckman Coulter will repair or replace the rotor free of charge.
4. If a Beckman Coulter rotor covered by this warranty is damaged due to a failure of a Beckman Coulter tube, bottle, tube cap, spacer, or adapter, covered under the Conditions of this Warranty, Beckman Coulter will repair or replace the rotor and repair the instrument as per the conditions in policy point (2) above, and the replacement policy.
5. Damage to a Beckman Coulter rotor or instrument due to the failure or malfunction of a non-Beckman Coulter tube, bottle, tube cap, spacer, or adapter is not covered under this warranty, although Beckman Coulter will assist in seeking compensation under the manufacturer's warranty.

Disclaimer

IT IS EXPRESSLY AGREED THAT THE ABOVE WARRANTY SHALL BE IN LIEU OF ALL WARRANTIES OF FITNESS AND OF THE WARRANTY OF MERCHANTABILITY AND BECKMAN COULTER, INC. SHALL HAVE NO LIABILITY FOR SPECIAL OR CONSEQUENTIAL DAMAGES OF ANY KIND WHATSOEVER ARISING OUT OF THE MANUFACTURE, USE, SALE, HANDLING, REPAIR, MAINTENANCE, OR REPLACEMENT OF THE PRODUCT.

Factory Rotor Inspection Service

Beckman Coulter, Inc., will provide free mechanical and metallurgical inspection in Indianapolis, Indiana, USA, of any Beckman Coulter rotor at the request of the user. (Shipping charges to Beckman Coulter are the responsibility of the user.) Rotors will be inspected in the user's laboratory if the centrifuge in which they are used is covered by an appropriate Beckman Coulter Service Agreement. Contact your local Beckman Coulter office for details of service coverage or cost.

Before shipping, contact the nearest Beckman Coulter Sales and Service office and request a Returned Goods Authorization (RGA) form and packaging instructions. Please include the complete rotor assembly, with buckets, lid, handle, tube cavity caps, etc. A SIGNED STATEMENT THAT THE ROTOR AND ACCESSORIES ARE NON-RADIOACTIVE, NON-PATHOGENIC, NON-TOXIC, AND OTHERWISE SAFE TO SHIP AND HANDLE IS REQUIRED.

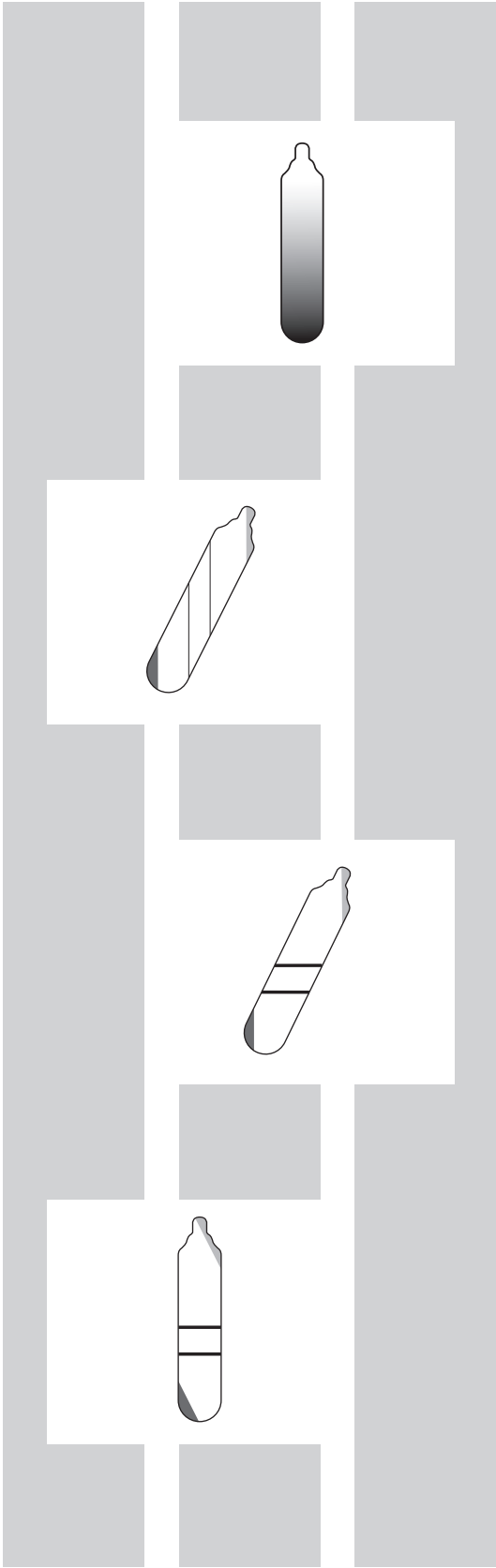

Related Documents

Rotors and Tubes for Preparative Ultracentrifuges (LR-IM)

- Rotors
- Tubes, Bottles, and Accessories
- Using Tubes, Bottles, and Accessories
- Using Fixed-Angle Rotors
- Using Swinging-Bucket Rotors
- Using Vertical-Tube and Near-Vertical Tube Rotors
- Care and Maintenance
- Chemical Resistances for Beckman Coulter Centrifugation Products
- Use of the w2t Integrator
- The Use of Cesium Chloride Curves
- Gradient Materials
- References
- Glossary

Available in hard copy or electronic pdf by request.

Rotors and Tubes CD (369668)

- Rotors and Tubes for Tabletop Preparative Ultracentrifuges
- Rotors and Tubes for J2, J6, Avanti J Series Centrifuges
- Rotors and Tubes for Preparative Ultracentrifuges
- Rotor Safety Bulletin
- Chemical Resistances for Beckman Coulter Centrifugation Products

Included with shipment of instrument.

Additional References

- Chemical Resistances for Beckman Coulter Centrifugation Products (IN-175)
- Beckman Coulter Ultracentrifuge Rotors, Tubes & Accessories catalog (BR-8101)
- Using OptiSeal Tubes (IN-189)
- Use and Care of Centrifuge Tubes and Bottles (IN-192)

Available in hard copy or electronic pdf by request.

Data Sheets

- *g*-Max System: Short Pathlengths in High Force Fields (DS-709B)

Available at www.beckmancoulter.com.

www.beckmancoulter.com

